

Installation Guide

Auxiliary Power Supplies for the M4350 Series Fully Managed Switches APS600Wv3, APS1200Wv2, and APS2000Wv2



Package contents

- Auxiliary power supply
- Power cord (varies by region)
- Installation guide

November 2023



201-30978-02

Overview

The APS600Wv3, APS1200Wv2, and APS2000Wv2 auxiliary power supplies (APS) are supported in the following M4350 series switch models:

- M4350-24X8F8V (SKU: XSM4340V)
- M4350-36X4V (SKU: XSM4340CV)
- M4350-32F8V (SKU: XSM4340FV)
- M4350-16V4C (SKU: VSM4320C)
- M4350-40X4C (SKU: XSM4344C)

Each APS has an LED that indicates the power supply status, as described in the following table.

LED	Status
Solid green	DC output is present and voltage is good.
Off	Loss of AC power occurred or AC power is not present.
Blinking green	AC power is present but DC output is for standby only.
Blinking amber	Warnings for abnormal events, like high operating temperature, high output current, slow fan, high output power.
Solid amber	A power supply failure occurred and the APS will be shut down.

Install an APS

In models with more than one power supply bay, you can install an additional APS.

1. Pull out the cover plate from the power module bay in which you want to insert the additional APS.
2. Insert the APS into the power module bay, and gently push the APS into the bay.
CAUTION: When inserting the APS, do not use unnecessary force. Doing so can damage the connectors on the back of the APS and on the midplane.
3. Connect the end of the power cord to the power receptacle on the APS.
4. Plug the AC power cord into a power source such as a wall socket or power strip.

Replace an APS

In models with more than one APS, the APSs are hot-pluggable.

1. If your switch functions with a single APS only, disconnect the power cord from the APS and let the switch power down.
If your switch functions with more than one APS, you do not need to power down the switch and you can perform a hot swap.
2. Remove the APS from the power module bay by doing the following:
 - a. Position the extraction handle perpendicular to the APS.
 - b. Insert your left index finger into the extraction handle.
 - c. Use your left thumb to move the orange release latch to the left and keep it in the release position.
 - d. Pull the extraction handle.

We recommend that you use your right hand to support the APS.

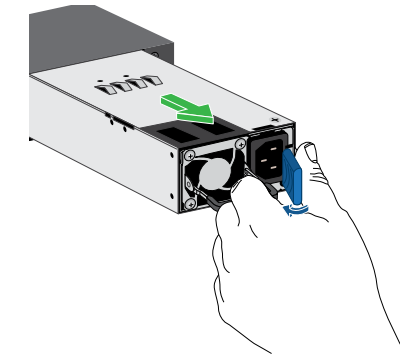

3. Insert the replacement APS into the power module bay, and gently push the APS into the bay until the latch locks.
CAUTION: When inserting the APS, do not use unnecessary force. Doing so can damage the connectors on the back of the APS and on the midplane.
4. Connect the end of the power cord to the power receptacle on the APS.
When you apply power, the LED on the APS lights. The LED on the switch for the power supply bay also lights. If these LEDs do not light, make sure that the power cord is plugged in and that the power source is good.

Technical specifications

Feature	APS Model	Specifications
AC input	APS600Wv3	100-120VAC, 8.5A, 50-60 Hz 200-240VAC, 4.5A, 50-60 Hz
	APS1200Wv2	100-120VAC, 12A, 50-60 Hz 200-240VAC, 10A, 50-60 Hz
	APS2000Wv2	100-120VAC, 12A, 50-60 Hz 200-240VAC, 10A, 50-60 Hz
DC output	APS600Wv3	+54.5VDC, 11.01A @ 90-132 VAC +54.5VDC, 11.01A @ 180-200VAC +54.5VDC, 11.01A @ 200-264VAC
	APS1200Wv2	+54.5VDC, 18.69A @ 90-132 VAC +54.5VDC, 22.43A @ 180-264 VAC
	APS2000Wv2	+54.5VDC, 18.69A, @ 90-132 VAC +54.5VDC, 33.64A, @ 180-198 VAC +54.5VDC, 37.38A, @ 198-264 VAC
Dimensions (H x W x D)	All models	1.6 x 2.9 x 7.3 in (40 x 73.5 x 185 mm)
Operating temperature	APS600Wv3	32°F to 131°F (0°C to 55°C)
	APS1200Wv2	32°F to 131°F (0°C to 55°C)
	APS2000Wv2	32°F to 122°F (0°C to 50°C)
Operating relative humidity	All models	5% to 85% relative humidity
Operating altitude level	All models	Up to 16,404 feet (5,000 m)
Storage temperature	APS600Wv3	-40°F to 176°F (-40°C to 80°C)
	APS1200Wv2	-40°F to 185°F (-40°C to 85°C)
	APS2000Wv2	-40°F to 176°F (-40°C to 80°C)
Storage altitude level	All models	Up to 49,859 feet (15,200 m)

Feature	APS Model	Specifications
MTBF	All models	Minimum MTBF at continuous operation of 250,000 hours, input voltage of 230VAC, inlet temperature of 104°F (40°C), and output load of 80%, as calculated by Bellcore Telcordia SR-332-Issue 2
Compliance - Safety	All models	CSA CE KC RCM CCC/CQC BIS BSMI
Compliance - EMC	All models	FCC ICES-003 CE VCCI KC RCM CCC/CQC BSMI

Warranty

Visit the NETGEAR warranty page to view the warranty information for your new NETGEAR device:

Australia:
www.netgear.com/au/about/warranty/



Japan:
www.netgear.com/jp/about/warranty/

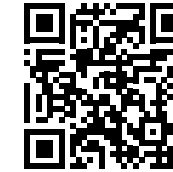

China:
www.netgear.com/cn/about/warranty/

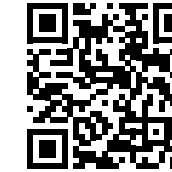

All other countries: Visit www.netgear.com/about/warranty/ and click the flag to select your country.

Support and Community

Visit netgear.com/support to get your questions answered and access the latest downloads.

You can also check out our NETGEAR Community for helpful advice at community.netgear.com.

Regulatory and Legal

Si ce produit est vendu au Canada, vous pouvez accéder à ce document en français canadien à netgear.com/support/download/. (If this product is sold in Canada, you can access this document in Canadian French at netgear.com/support/download/.) For regulatory compliance information including the EU Declaration of Conformity, visit netgear.com/about/regulatory/. See the regulatory compliance document before connecting the power supply. For NETGEAR's Privacy Policy, visit netgear.com/about/privacy-policy. By using this device, you are agreeing to NETGEAR's Terms and Conditions at netgear.com/about/terms-and-conditions. If you do not agree, return the device to your place of purchase within your return period.

Do not use this device outdoors. If you connect cables or devices that are outdoors to the switch, see kb.netgear.com/000057103 for safety and warranty information.

Applicable to 6 GHz devices only: Only use the device indoors. The operation of 6 GHz devices is prohibited on oil platforms, cars, trains, boats, and aircraft, except that operation of this device is permitted in large aircraft while flying above 10,000 feet. Operation of transmitters in the 5.925-7.125 GHz band is prohibited for control of or communications with unmanned aircraft systems.

根据中国 RoHS 要求，查看本产品中有害物质的相关信息，请登录下面链接后点击对应产品型号名称：
<http://support.netgear.cn/China-RoHS>

NETGEAR, Inc.
350 East Plumeria Drive
San Jose, CA 95134, USA

NETGEAR INTERNATIONAL LTD
Floor 6, Penrose Two,
Penrose Dock, Cork, T23 YY09, Ireland

© NETGEAR, Inc., NETGEAR and the NETGEAR Logo are trademarks of NETGEAR, Inc. Any non-NETGEAR trademarks are used for reference purposes only.